

Change the name of the mobile hotspot.
 WiFi Network name (SSID) : gne-s
 Password: 1234512345
Note: This is the default WiFi connection for the new Beehive/BeeBox-H.

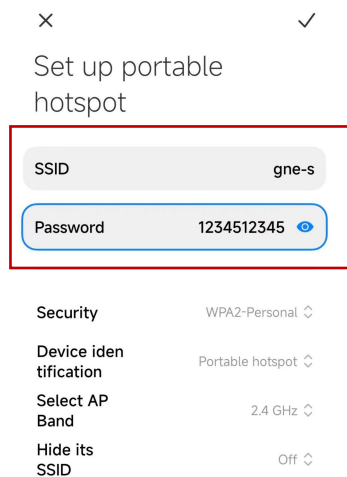

After the Beehive/BeeBox-H is powered on, wait for the phone hotspot to be connected.

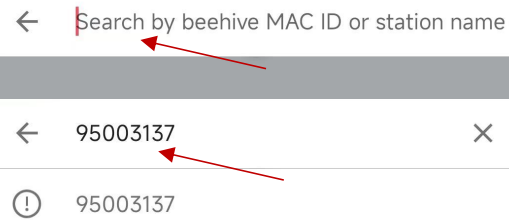
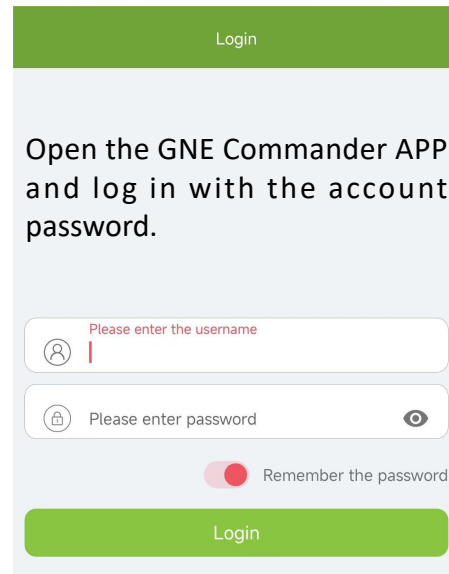
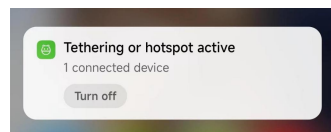

Search for an aggregator MAC ID.

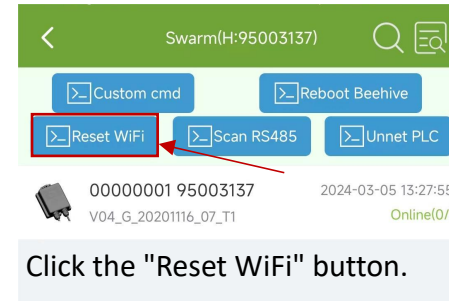

Click the "Reset WiFi" button.

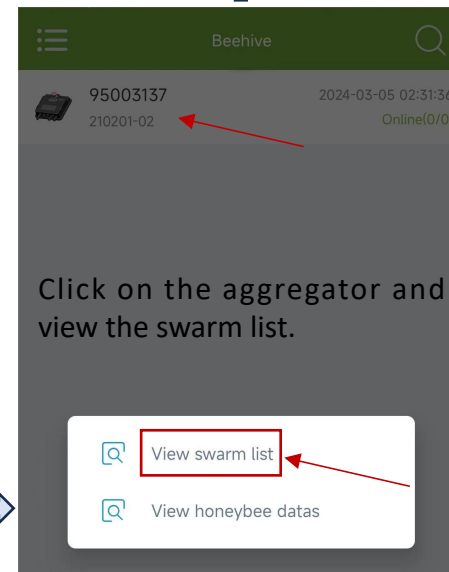

Click on the aggregator and view the swarm list.

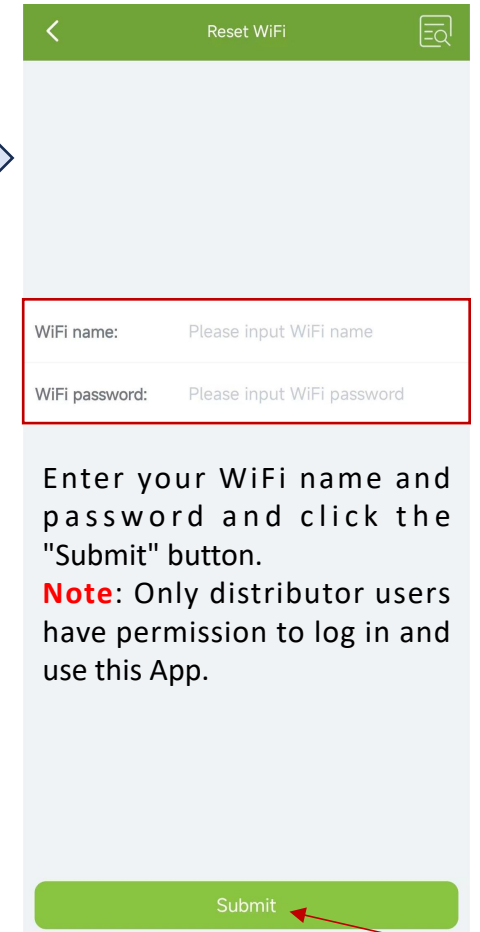

Enter your WiFi name and password and click the "Submit" button.

Note: Only distributor users have permission to log in and use this App.