

## System analysis

- Sliding rollder system
- Hanging sliding roller accessory kit

### Perfect A21 High-track Single-door Set

Inner Packing Specification	Outer Packing Specification	SAP Code
1 set/box	20 boxes/case	CA420003-002



Single door width	≥600mm
Single door thickness	40 or 45mm
Suitable for Glass Thickness	8~11mm
Single door load bearing	≤80kg

#### Order instructions

- Please order the profiles and tracks separately
- 2-Overlap sliding doors: Please order 2 sets of Perfect A21 high track single door set

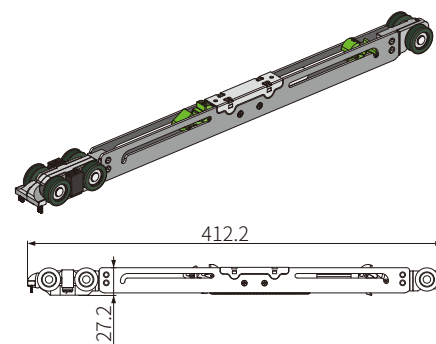

Product name	Quantity	SAP Code
Synchronized door rolling out stopper	x2	CA991363-001

Product name	Quantity	SAP Code
Single hanging sliding roller	x1	CA991383-001

Product name	Quantity	SAP Code
Synchronized damping hanging sliding roller	x1	CA991384-001

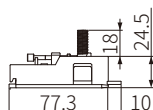
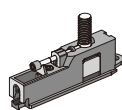

Product name	Quantity	SAP Code
Perfect A01-Hanging Box	x2	CA991441-001

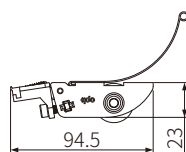
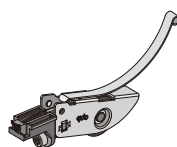

Product name	Quantity	SAP Code
Anti-swing wheel	x2	CA991387-001

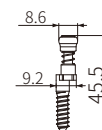
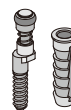

Product name	Quantity	SAP Code
the floor guide wheel	x1	CA991393-001

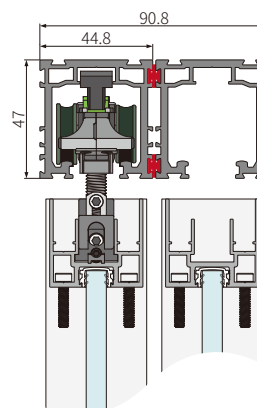

See page 39 for more details

#### More matching

- See page 39 for available Tracks
- See pages 43~48 for available Door Frame
- See pages 49 for available Door Cover

See pages 65~66 for the Solution Diagram

## System analysis

- Sliding rollder system
- Schematic diagram of the Hanging sliding roller Installation

### Split sliding roller Installation

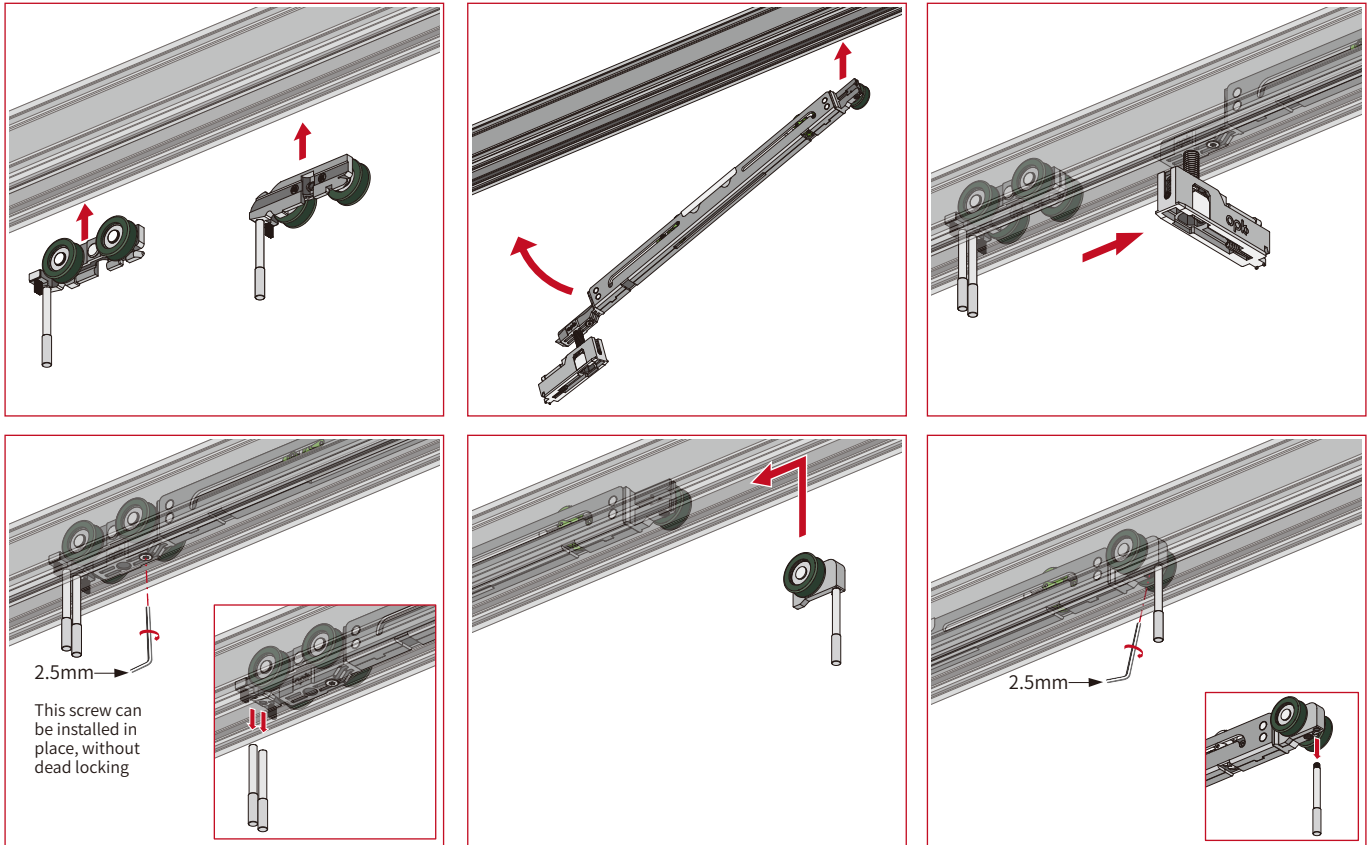

### after-installing damper

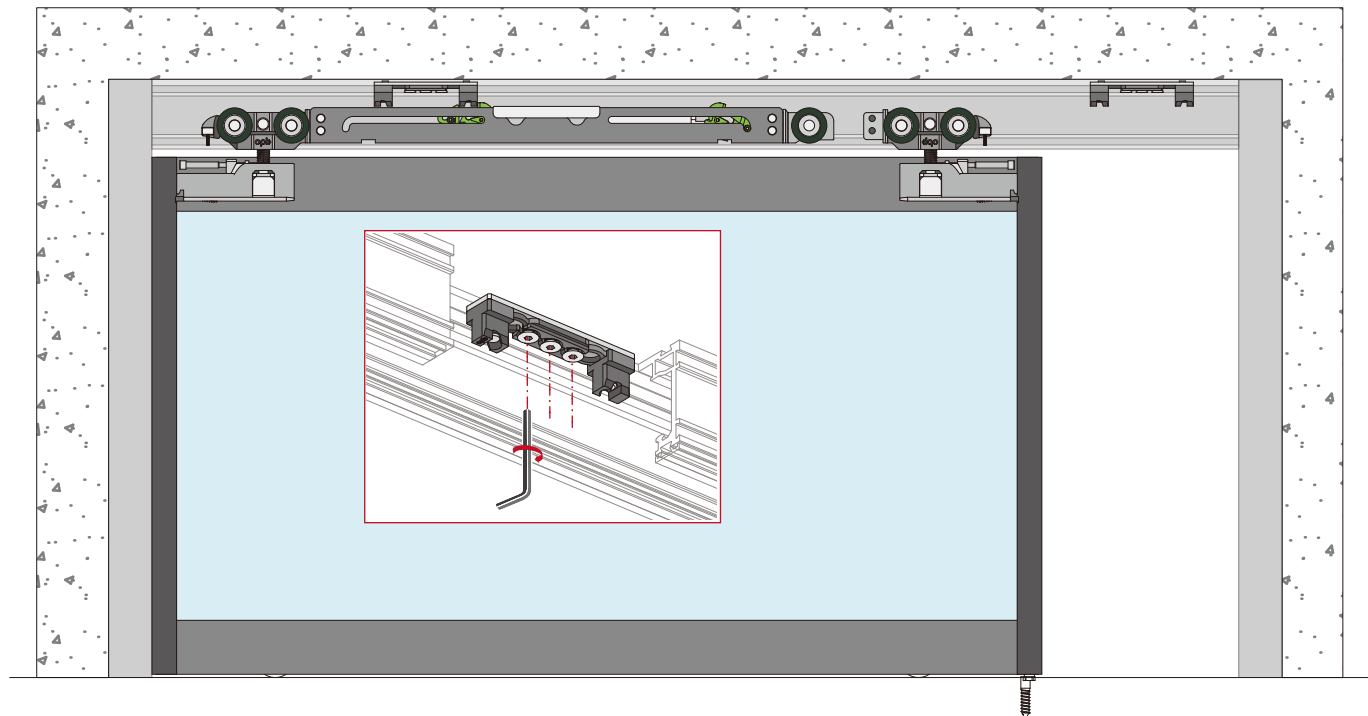

## System analysis

- Sliding rollder system
- Hanging sliding roller accessory kit

### Perfect A21 High-track Single-door Set(with linkage accessories)

Inner Packing Specification	Outer Packing Specification	SAP code
1 set/box	20 Sets /Carton	CA420003-003

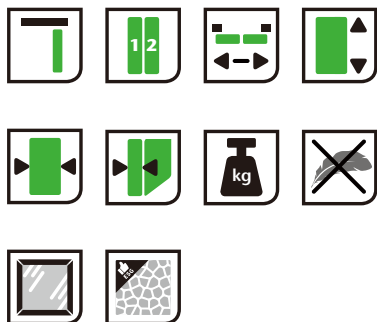

Single door width	Depending on the single-door set
Single door thickness	40mm
Suitable for Glass Thickness	8~11mm
Single door load bearing	≤60kg

#### Order instructions

- Please order the profiles and tracks separately
- Synchronized Linkage Door: Please order one set of Perfect A21 high track single door set (With linkage accessories) and one set of Perfect A21 high track single door set

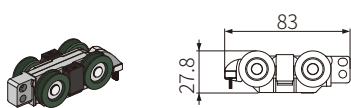

Product name	Quantity	SAP Code
Single hanging sliding roller	x1	CA991383-001

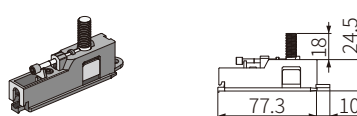

Product name	Quantity	SAP Code
Perfect A01-Hanging Box	x2	CA991441-001

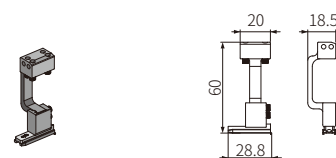

Product name	Quantity	SAP code
Synchronized linkage assembly	x2	CA991361-001

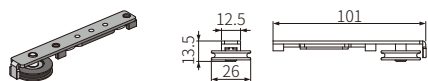

Product name	Quantity	SAP code
Synchronized door reel	x2	CA991362-001

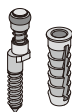

Product name	Quantity	SAP Code
the floor guide wheel	x1	CA991393-001

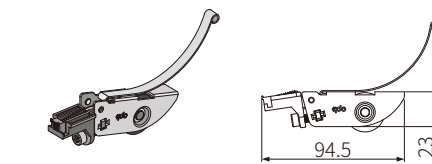
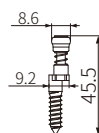

Product name	Quantity	SAP Code
Anti-swing wheel	x2	CA991387-001



Product name	Quantity	SAP code
Plastic coated wire rope	x1	125693

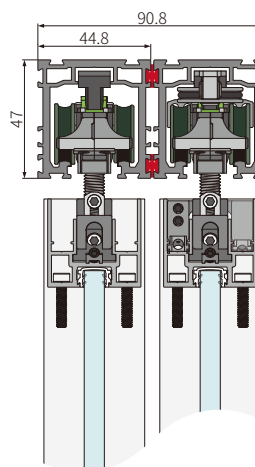

See page 39 for more details

#### More matching

- See page 39 for available Tracks
- See pages 43~48 for available Door Frame
- See pages 49 for available Door Cover

See pages 65~66 for the Solution Diagram

## System analysis

- Sliding roller system
- Schematic diagram of the Hanging sliding roller Installation

Install the fittings in the track

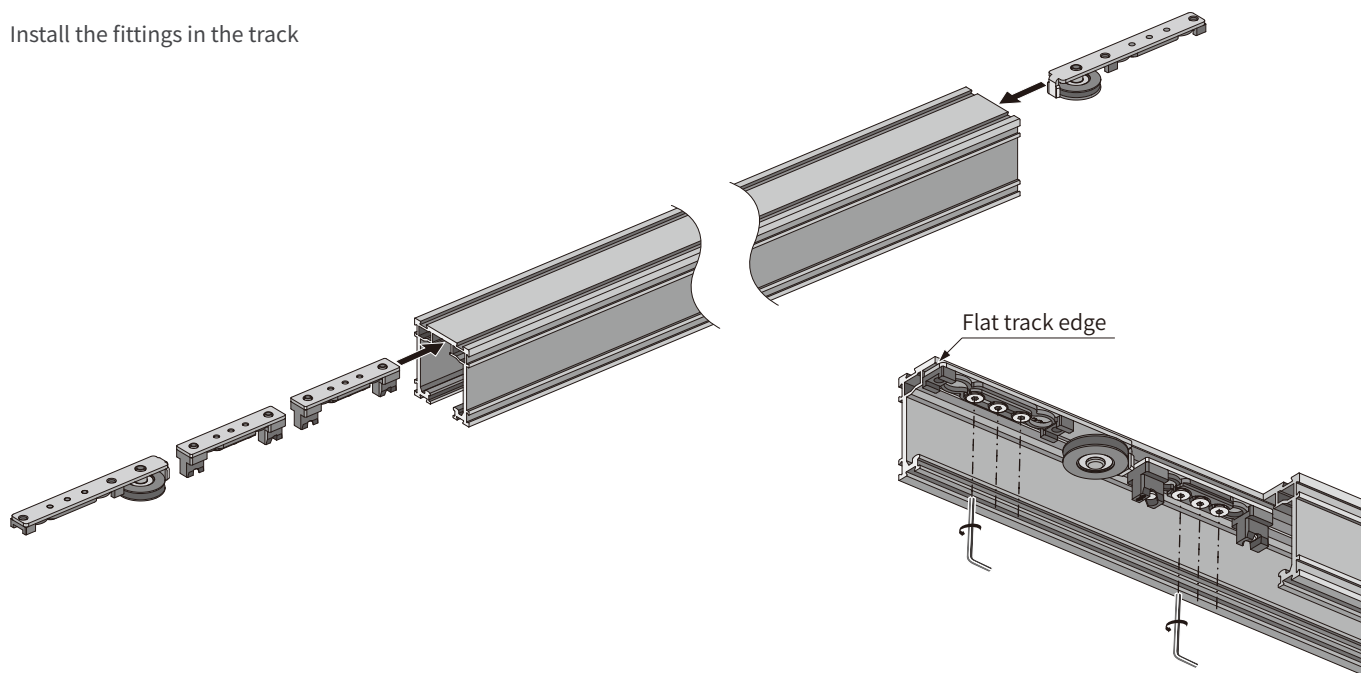

Wound steel wire

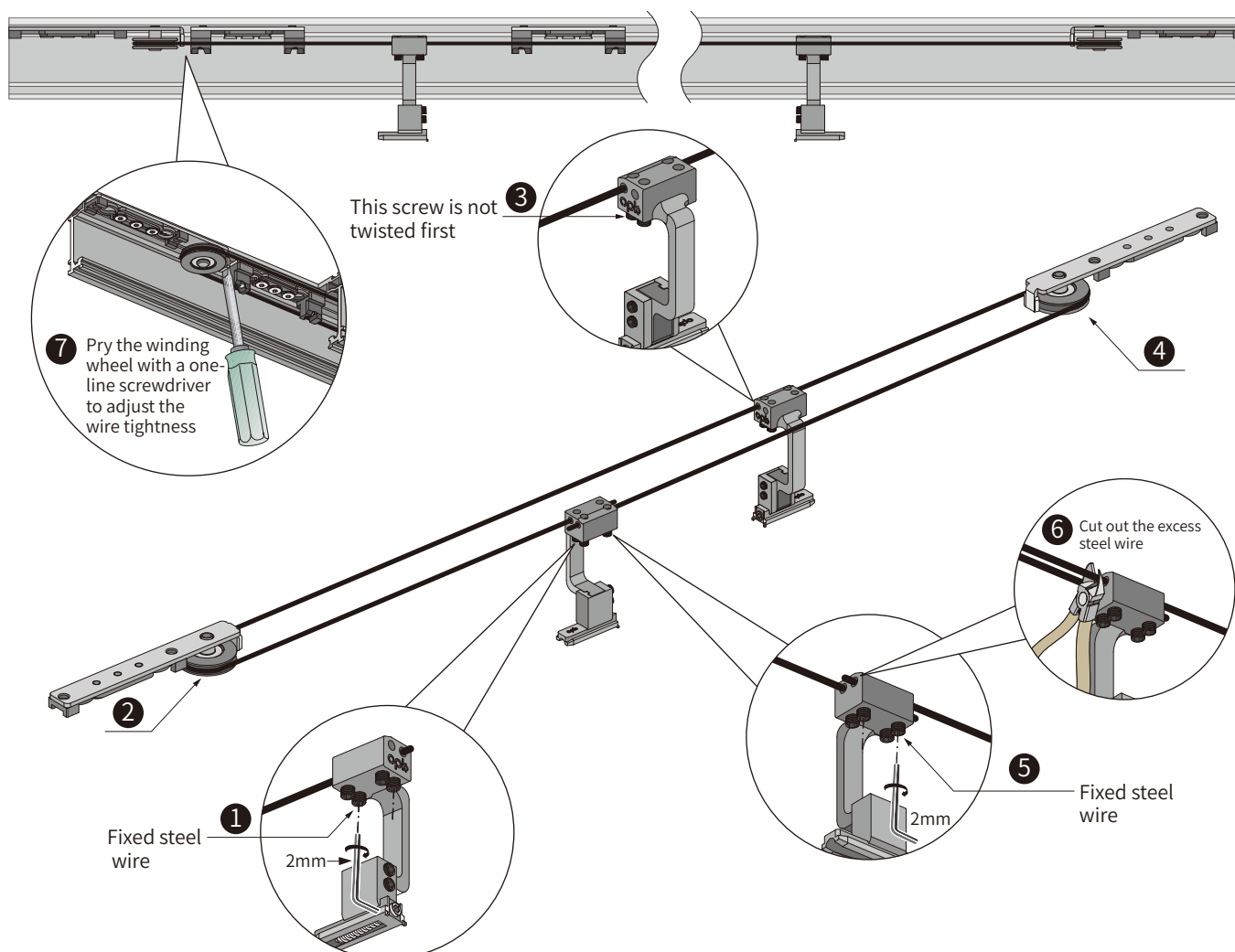

## System analysis

- Track system
- Hanging sliding track profile

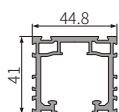
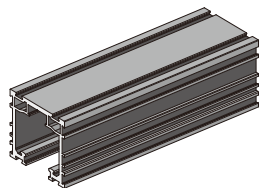

### Technical Overview

- Meter Weight: 1.35kg/m
- Material: Aluminum Alloy
- Surface Treatment: oxidized flat light black
- Length: 6000mm

### Usage Instructions

- Used with the Hanging sliding roller system
- Length can be customized according to demand
- Pre-drilling and Screw fixation

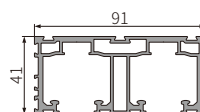
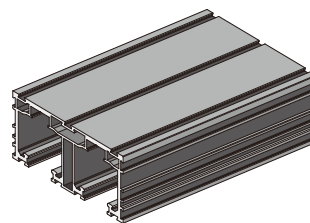

### Technical Overview

- Meter Weight: 2.14kg/m
- Material: Aluminum Alloy
- Surface Treatment: oxidized flat light black
- Length: 6000mm

### Usage Instructions

- Apply to 2 Overlap sliding doors
- can be combined with the Hanging sliding track into 3 Linkage door or 2 Linkage doors with one free door
- Length can be customized according to demand
- Pre-drilling and Screw fixation

Product name	Model Number
Hanging sliding track	OPK-A101

Product name	Model Number
40Hanging sliding double track	OPK-A114-40

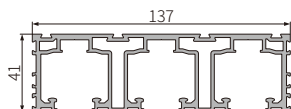
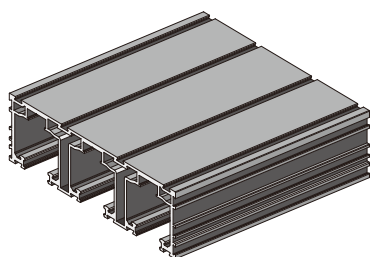

### Technical Overview

- Material: Aluminum Alloy
- Surface Treatment: oxidized flat light black
- Length: 6000mm

### Usage Instructions

- Used with the Hanging sliding roller system
- Apply to 3 Linkage door or 2 Linkage doors with one free door

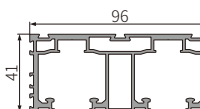
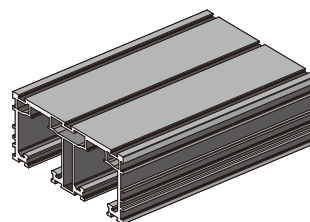

### Technical Overview

- Material: Aluminum Alloy
- Surface Treatment: oxidized flat light black
- Length: 6000mm

### Usage Instructions

- Apply to 2 Overlap sliding doors
- can be combined with the Hanging sliding track into 3 Linkage door or 2 Linkage doors with one free door
- Length can be customized according to demand
- Pre-drilling and Screw fixation

Product name	Model Number
40 Hanging Sliding Roller Track for 3 Sliding Track	OPK-A116-40

Product name	Model Number
45 Hanging Sliding Roller Track for Double Sliding Track	OPK-A118-45

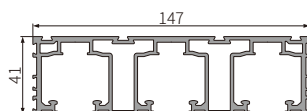
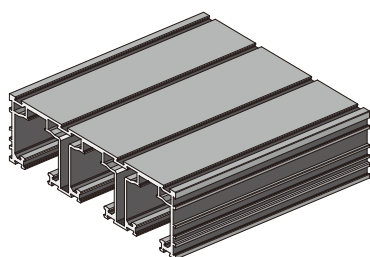

### Technical Overview

- Material: Aluminum Alloy
- Surface Treatment: oxidized flat light black
- Length: 6000mm

### Usage Instructions

- Used with the Hanging sliding roller system
- Apply to 3 Linkage door or 2 Linkage doors with one free door

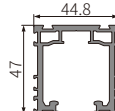
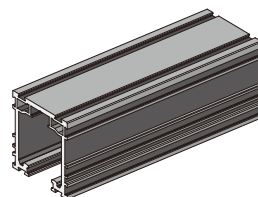

### Technical Overview

- Meter Weight: 1.21kg/m
- Material: Aluminum Alloy
- Surface Treatment: oxidized flat light black
- Length: 6000mm

### Usage Instructions

- apply to Synchronized Linkage Door
- Length can be customized according to demand
- Pre-drilling and Screw fixation

Product name	Model Number
45 Hanging Sliding Roller Track for 3 Sliding Track	OPK-A120-45

Product name	Model Number
Hanging sliding high track(apply to Synchronized Linkage Door)	OPK-A102

## System analysis

- Track system
- Hanging sliding track profile

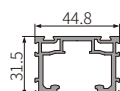
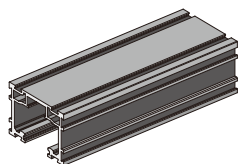

### Technical Overview

- Meter Weight: 0.99kg/m
- Material: Aluminum Alloy
- Surface Treatment: oxidized flat light black
- Length: 6000mm

### Usage Instructions

- Pair with the Perfect system-30 low track opposite damping hanging sliding track set
- Length can be customized according to demand
- Pre-drilling and Screw fixation

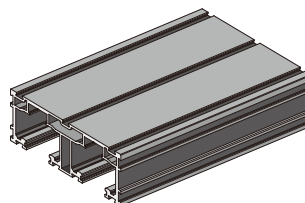

### Technical Overview

- Meter Weight: 1.77kg/m
- Material: Aluminum Alloy
- Surface Treatment: oxidized flat light black
- Length: 6000mm

### Usage Instructions

- Pair with the Perfect system-30 low track opposite damping hanging sliding track set
- Length can be customized according to demand
- Pre-drilling and Screw fixation

Product name	Model Number
Hanging sliding low track	OPK-A123

Product name	Model Number
40 Hanging sliding low double track	OPK-A124-40

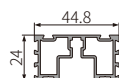
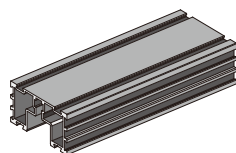

### Technical Overview

- Meter Weight: 0.68kg/m
- Material: Aluminum Alloy
- Surface Treatment: oxidized flat light black
- Length: 6000mm

Product name	Model Number
The Bottom load-bearing is matched with the Top sliding track	OPK-A112

## System analysis

- Door frame system
- 4016 door frame

### Technical Overview

- Meter Weight: 0.76kg/m
- Material: Aluminum Alloy
- Surface Treatment: Enamelled copper/Cypress grey/Titanium void grey
- Length: 6000mm

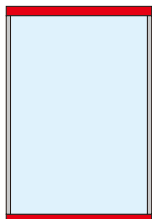
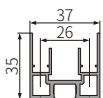
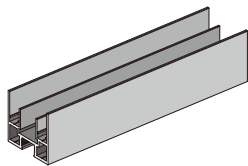

### Technical Overview

- Meter Weight: 0.45kg/m
- Material: Aluminum Alloy
- Surface Treatment: Enamelled copper/Cypress grey/Titanium void grey
- Length: 6000mm

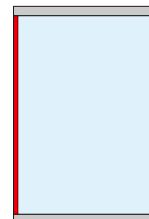
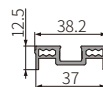
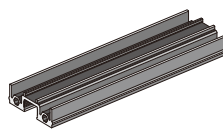

Product name	Model Number
40 door frame top and bottom frame	OPK-A201-40

Product name	Model Number
40 door frame mullion(inside)	OPK-A202-40

### Technical Overview

- Meter Weight: 0.27kg/m
- Material: Aluminum Alloy
- Surface Treatment: Enamelled copper/Cypress grey/Titanium void grey
- Length: 6000mm

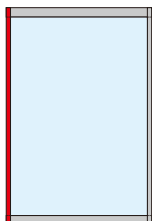
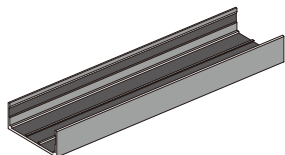

### Technical Overview

- Meter Weight: 0.29kg/m
- Material: Aluminum Alloy
- Surface Treatment: Enamelled copper/Cypress grey/Titanium void grey
- Length: 6000mm

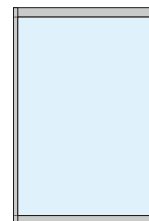
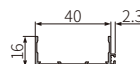
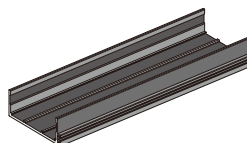

Product name	Model Number
40 door frame mullion(outside)	OPK-A203-40

Product name	Model Number
40 door frame mullion(External clasp)	OPK-A204-40

### Technical Overview

- Meter Weight: 0.35kg/m
- Material: Aluminum Alloy
- Surface Treatment: Enamelled copper/Cypress grey/Titanium void grey
- Length: 6000mm

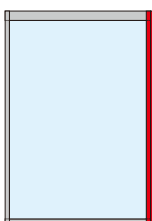
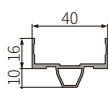
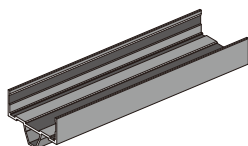

### Technical Overview

- Meter Weight: 0.48kg/m
- Material: Aluminum Alloy
- Surface Treatment: Enamelled copper/Cypress grey/Titanium void grey
- Length: 6000mm

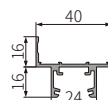
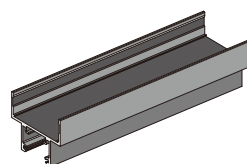

Product name	Model Number
40 synchronized door cover A	OPK-A207-40

Product name	Model Number
40 synchronized door cover B	OPK-A208-40

## System analysis

- Door frame system
- 4016 door frame

### Technical Overview

- Meter Weight: 0.41kg/m
- Material: Aluminum Alloy
- Surface Treatment: Enamelled copper/Cypress grey/Titanium void grey
- Length: 6000mm

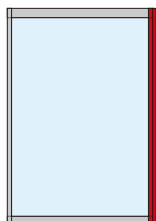
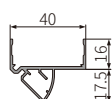
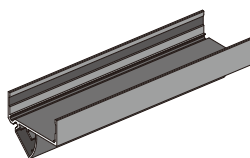

Product name	Model Number
40 right-angle synchronized door cover (arc surface)	OPK-A206-40

### — Schematic diagram of the Door frame system Installation

#### Top and bottom horizontal frame opening dimensions

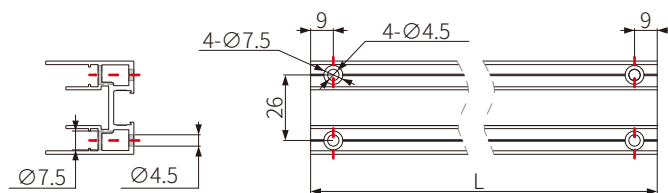

#### Install glass rubber strips

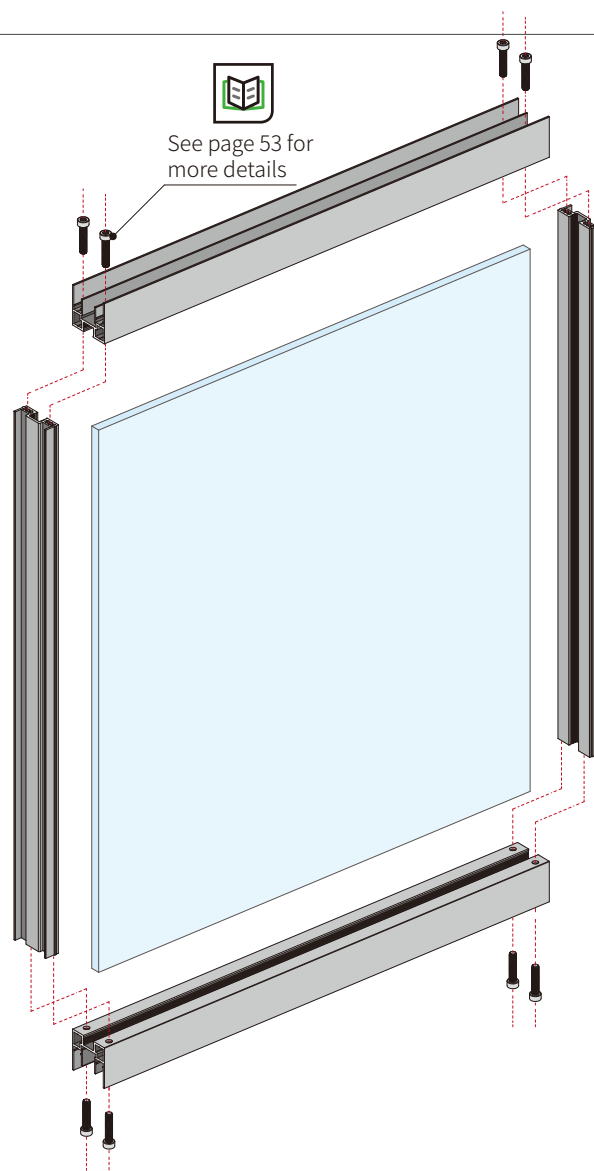
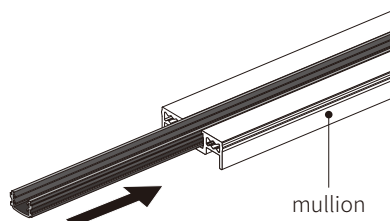
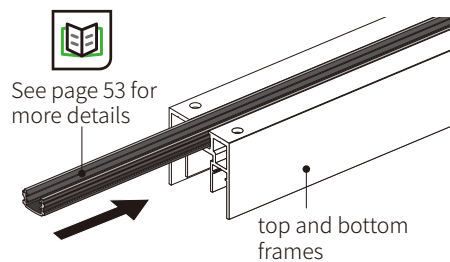



## System analysis

- Auxiliary accessories system
- Door frame auxiliary accessories

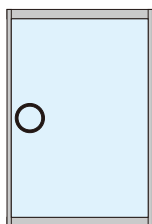
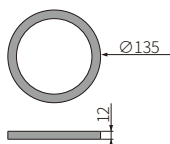

### Technology general situation

- Material: Aluminum Alloy
- Surface Treatment:

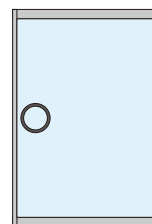
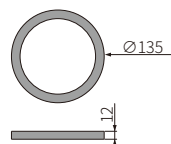

### Technology general situation

- Material: Aluminum Alloy
- Surface Treatment:



Product name	Model Number	SAP code
Perfect Round Handle # 1 (Two-color)135mm_Perfect metal black	OPK-A533	CA991626-001
Perfect Round Handle # 1 (Two-color)135mm_Perfect porcelain Swimming Ash	OPK-A533	CA991626-002
Perfect Round Handle # 1 (Two-color)135mm_Perfect Mocaffine	OPK-A533	CA991626-003
Perfect Round Handle # 1 (Two-color)135mm_Perfect moonlight grey	OPK-A533	CA991626-004

Product name	Model Number	SAP code
Perfect Round Handle # 1 (one-color)135mm_Perfect metal black	OPK-A534	CA991629-001
Perfect Round Handle # 1 (one-color)135mm_Perfect porcelain Swimming Ash	OPK-A534	CA991629-002
Perfect Round Handle # 1 (one-color)135mm_Perfect Mocaffine	OPK-A534	CA991629-003
Perfect Round Handle # 1 (one-color)135mm_Perfect moonlight grey	OPK-A534	CA991629-004

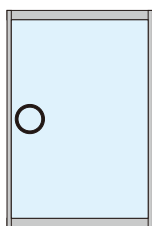
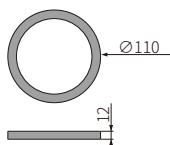

### Technology general situation

- Material: Aluminum Alloy
- Surface Treatment:

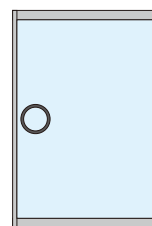
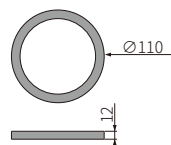

### Technology general situation

- Material: Aluminum Alloy
- Surface Treatment:



Product name	Model Number	SAP code
Perfect Round Handle # 1 (Two-color)110mm_Perfect metal black	OPK-A535	CA991627-001
Perfect Round Handle # 1 (Two-color)110mm_Perfect porcelain Swimming Ash	OPK-A535	CA991627-002
Perfect Round Handle # 1 (Two-color)110mm_Perfect Mocaffine	OPK-A535	CA991627-003
Perfect Round Handle # 1 (Two-color)110mm_Perfect moonlight grey	OPK-A535	CA991627-004

Product name	Model Number	SAP code
Perfect Round Handle # 1 (one-color) 110mm_Perfect metal black	OPK-A536	CA991628-001
Perfect Round Handle # 1 (one-color) 110mm_Perfect porcelain Swimming Ash	OPK-A536	CA991628-002
Perfect Round Handle # 1 (one-color) 110mm_Perfect Mocaffine	OPK-A536	CA991628-003
Perfect Round Handle # 1 (one-color) 110mm_Perfect moonlight grey	OPK-A536	CA991628-004

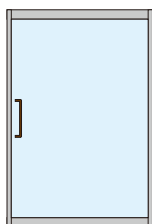
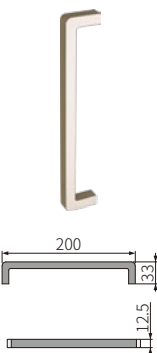

### Technology general situation

- Material: Aluminum Alloy
- Surface Treatment:

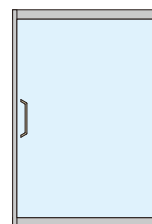
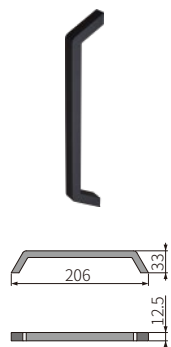

### Technology general situation

- Material: Aluminum Alloy
- Surface Treatment:



Product name		Inner Packing Specification	Outer Packing Specification	Model Number	SAP code
Perfect U-shaped handle # 1	Perfect metal black	Ten boxes/box	20 boxes/case	OPK-A519	CA991574-007
	Perfect porcelain Swimming Ash	Ten boxes/box	20 boxes/case	OPK-A519	CA991574-008
	Perfect Mocaffine	Ten boxes/box	20 boxes/case	OPK-A519	CA991574-006
	Perfect moonlight grey	Ten boxes/box	20 boxes/case	OPK-A519	CA991574-009

Product name		Inner Packing Specification	Outer Packing Specification	Model Number	SAP code
Perfect boat type handle # 1	Perfect metal black	Ten boxes/box	20 boxes/case	OPK-A518	CA991574-011
	Perfect porcelain Swimming Ash	Ten boxes/box	20 boxes/case	OPK-A518	CA991574-012
	Perfect Mocaffine	Ten boxes/box	20 boxes/case	OPK-A518	CA991574-010
	Perfect moonlight grey	Ten boxes/box	20 boxes/case	OPK-A518	CA991574-013

Use technology to perfect life, And to make industry-benign sustainable development

## System analysis

- Auxiliary accessories system
- Door frame auxiliary accessories

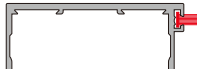
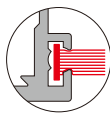

### Usage Instruction

- Use with door mullion (External clasp)

Product name	Inner Packing Specification	Outer Packing Specification	Model Number	SAP code
Sealing strip for clasp	500 m/roll	4 roll/case	OPK-A403	653926

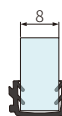
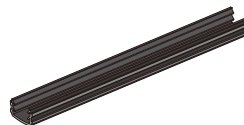

### Technical overview

- Material: PVC
- Finish Treatment: Black

### Usage Instruction

- Can be used for 8mm thick single glass

Product name	Inner Packing Specification	Outer Packing Specification	Model Number	SAP code
8mm Glass rubber strip	3.5m/piece	100 strips/tie	OPK-A408	653889



### Technical overview

- Material: PVC
- Finish Treatment: Black

### Usage Instruction

- can be used for 4mm+4mm thick laminated glass

Product name	Inner Packing Specification	Outer Packing Specification	Model Number	SAP code
9mm Glass rubber strip	3.5m/piece	100 strips/tie	OPK-A409	653822



### Technical overview

- Material: PVC
- Finish Treatment: Black

### Usage Instruction

- Can be used for 10mm thick single glass

Product name	Inner Packing Specification	Outer Packing Specification	Model Number	SAP code
10mm Glass rubber strip	3.5m/piece	100 strips/tie	OPK-A410	653890

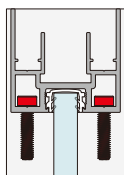
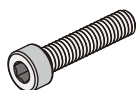

### Technical overview

- Material: carbon steel
- Surface Treatment: nickel plating

### Usage Instruction

- For the connection of the door system
- Eight piece for a door

Product name	Inner Packing Specification	Outer Packing Specification	Model Number	SAP code
internal Hexagonal self-tapping machine wire	500 piece/bag	24 bag/case	OPK-A503	141325

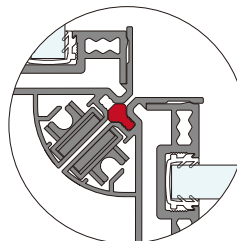

### Technical overview

- Material: rubber
- Surface Treatment: Black

### Usage Instruction

- For shock-proof and dust-proof synchronized decorative door cover

Product name	Inner Packing Specification	Outer Packing Specification	Model Number	SAP code
Right angle synchronized sealing rubber strip	400m/roll	2roll/case	OPK-A405	653763

## Application solution

- Hanging sliding Synchronized linkage door
- The hanging concealed track



### Door Opening Top View

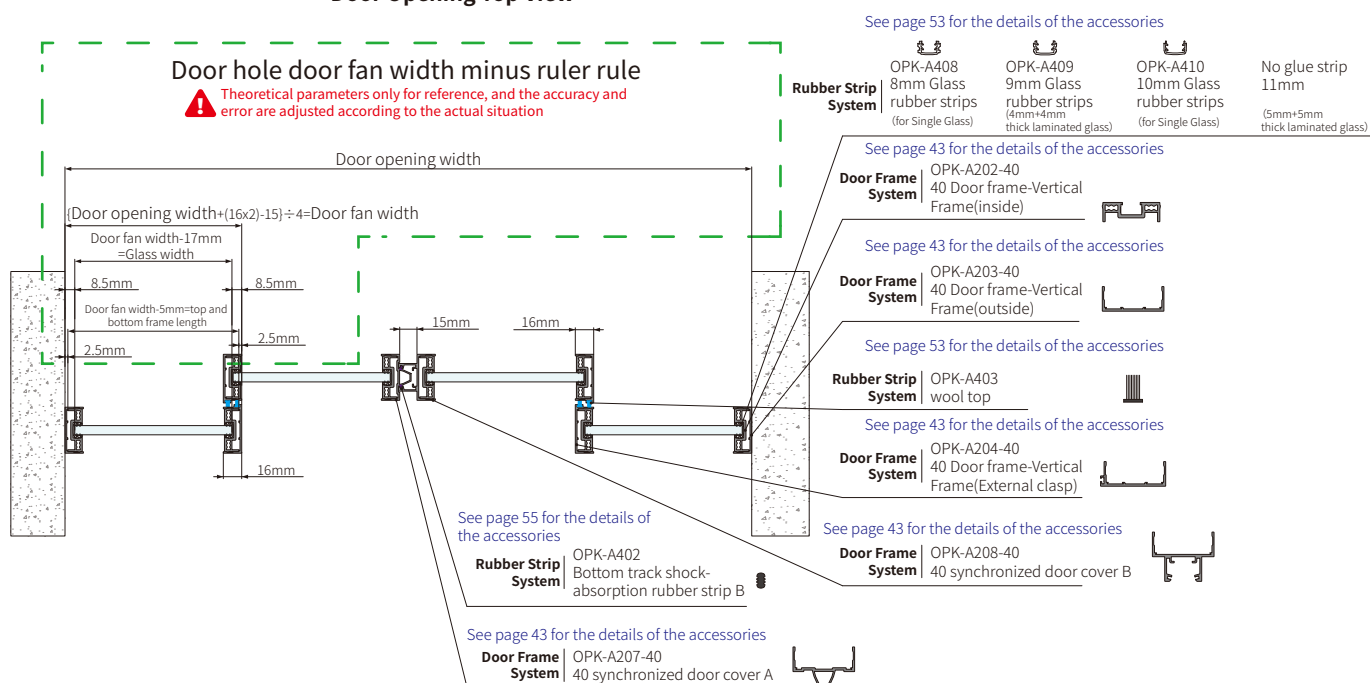

## Application solution

- Hanging sliding Synchronized linkage door
- The hanging concealed track

### Door opening front view

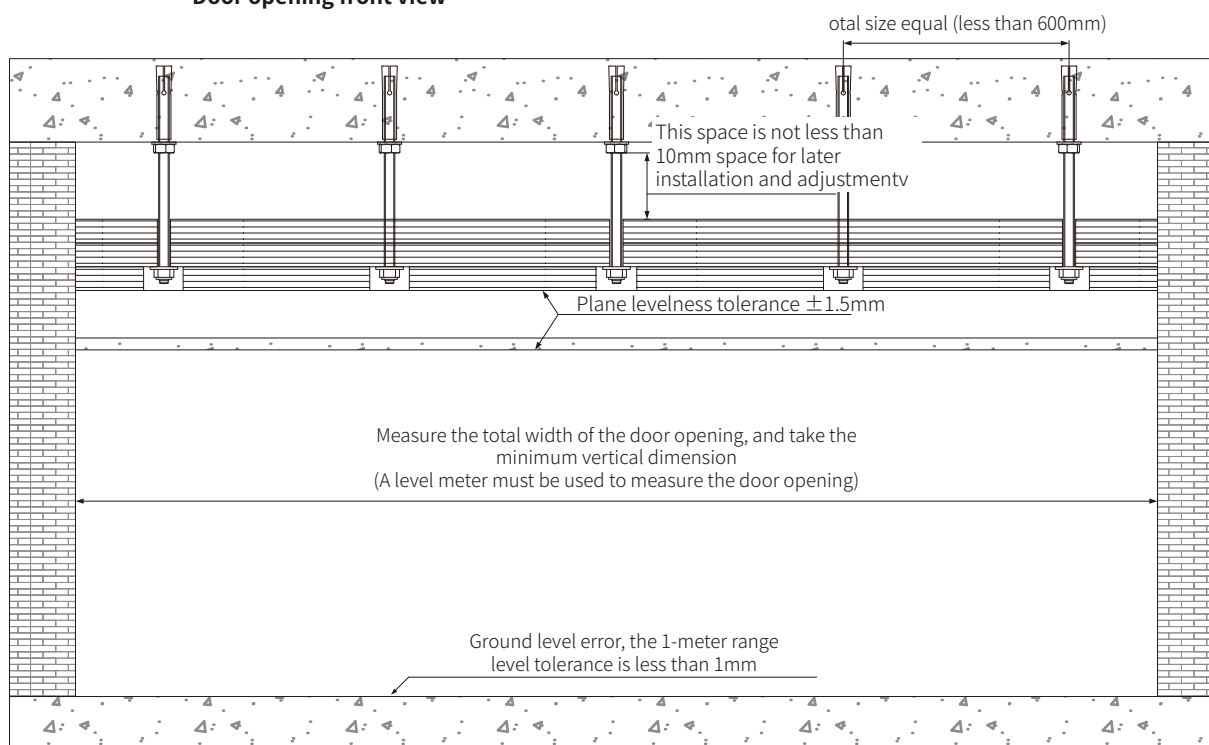

### Door opening sectional view

