

1 Product technical features

1 Door panel anti-jumping settings

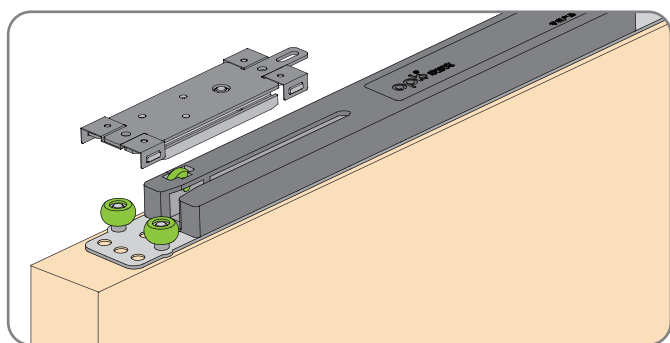

Adjust toggle member up and down by utilizing this screw

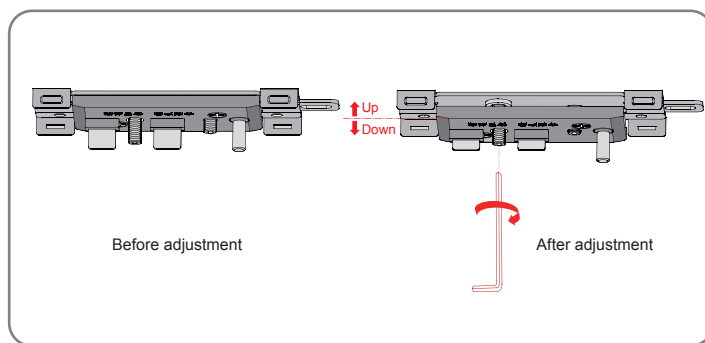

2 Bottom roller installation options

A style

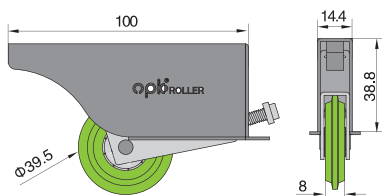

B style

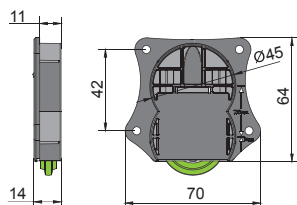

C style

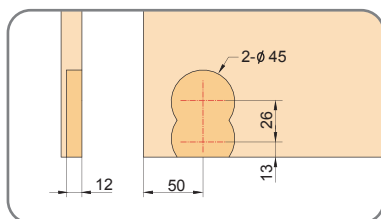
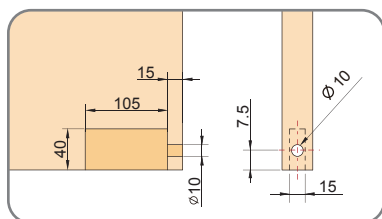
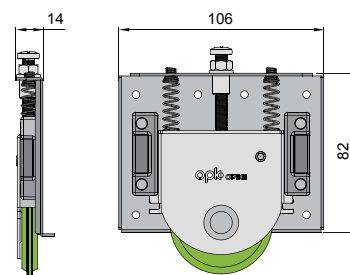

2 Cabinet requirements

A style

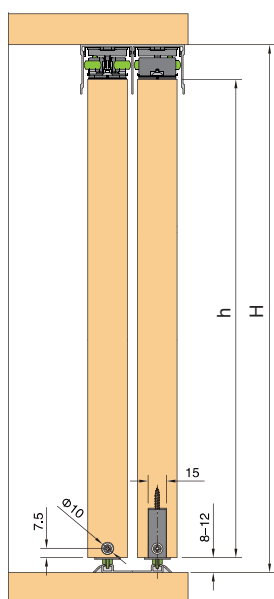

Door height(h)=H-43mm

B style

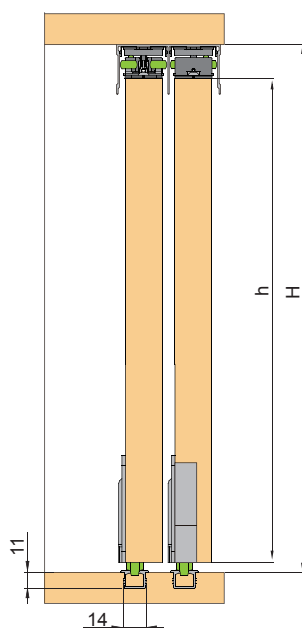

Door height(h)=H-38mm

C style

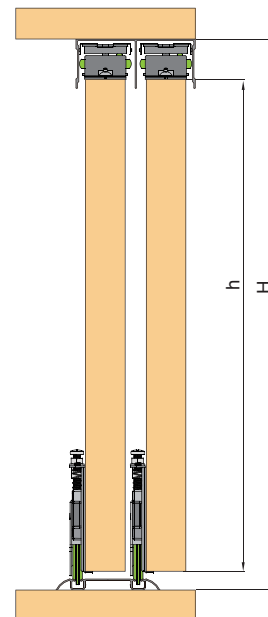

Door height(h)=H-43mm

3 Installation steps:

1 Install damping top roller

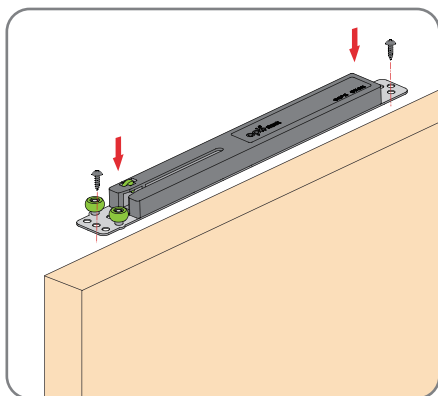

A style

2 Install flat top roller

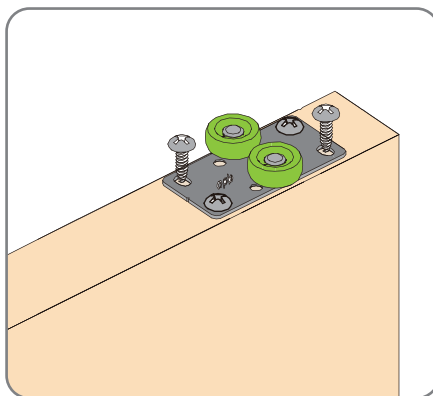

B style

3 Install bottom roller

A style

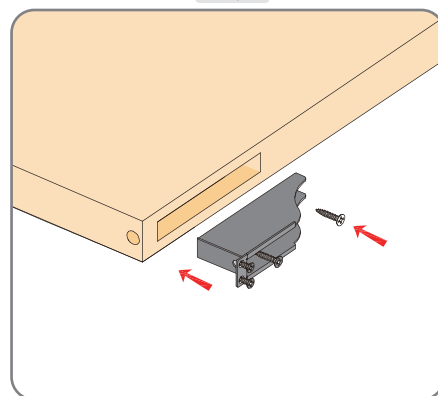

C style

4 Install the door panel

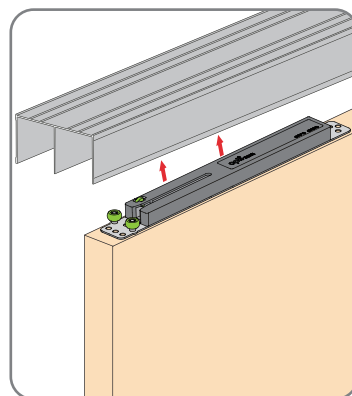
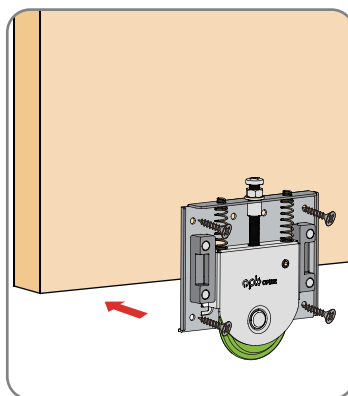
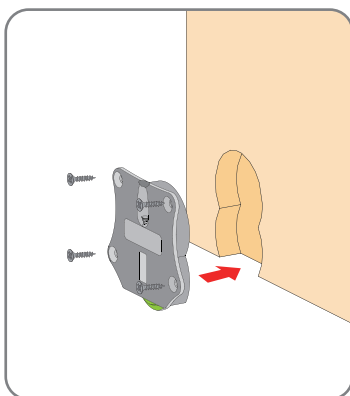
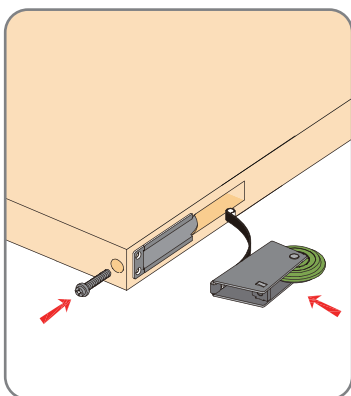

5 Adjust the door balance (adjust the bottom rollers)

A style

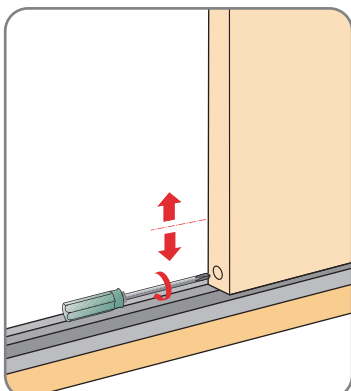

B style

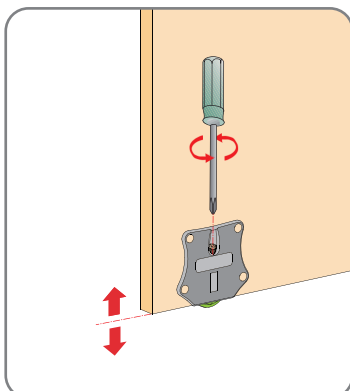

C style

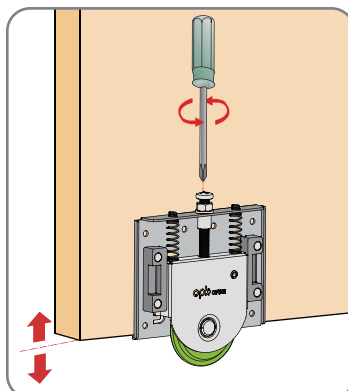

6 Anti-jumping stopper installation

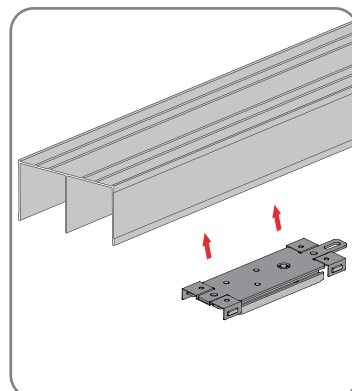

7 Positioning Anti-jumping stopper

1. Push the door to the side

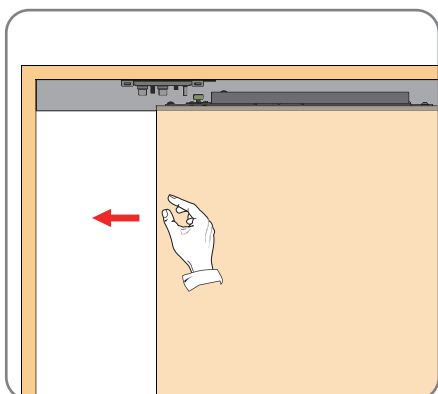

2. Anti-jumping stopper into place

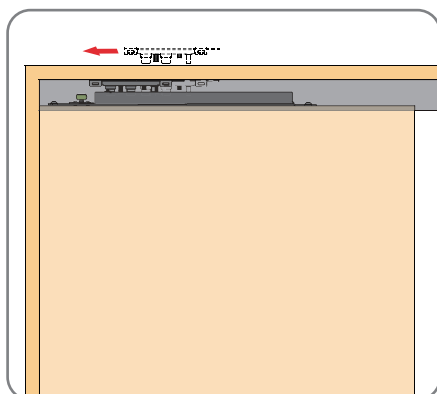

3. Fix the anti-jumping stopper

